

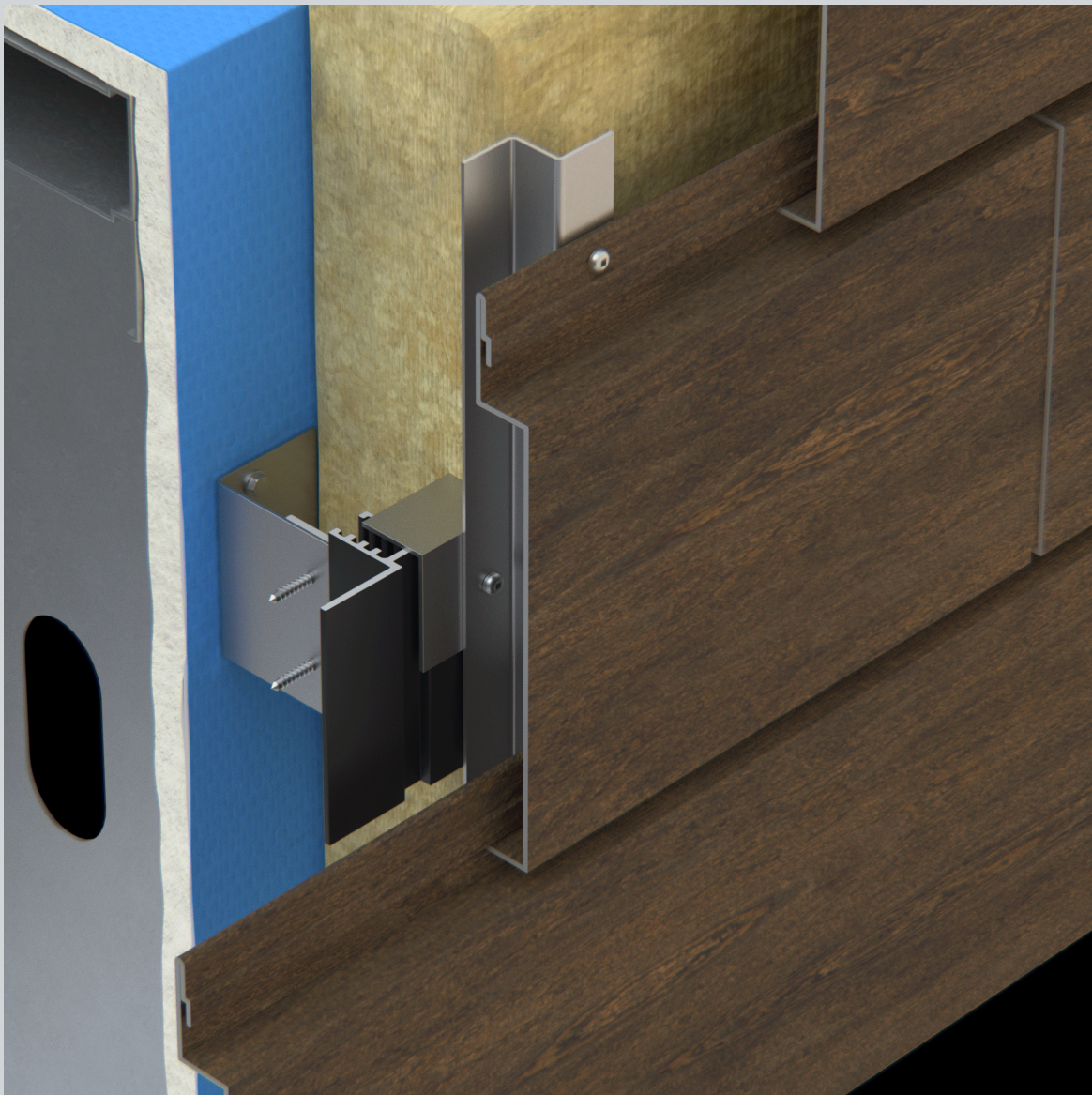

KEITH PANEL SYSTEMS

PLANK PROFILE

Extruded Aluminum Facade Panel





Project: *Concord Pacific - Hillside West* | Location: *Burnaby, BC, Canada* | Architect: *James K.M. Cheng Architects / Buttjes Architecture*

P L A N K P R O F I L E

The KPS Plank Profile is an interlocking, nominal 8" wide, extruded aluminum profile. The unique deep reveal connection helps to accentuate the divisions between the planks. The robust wall thickness of the aluminum delivers an exceptionally flat surface without oil-canning. It is suitable for Rainscreen wall application, and is particularly effective for soffits — especially where a powdercoated woodgrain finish is desired. Custom colours are also available. This product is suitable for Noncombustible Construction.

- Suitable for Rainscreen walls & soffits
- Extruded Aluminum remains exceptionally flat
- Deep reveal to accentuate the planks
- Woodgrain finishes and custom colours available
- Compatible with thermally improved clips
- Noncombustible

 Unit 400 – 3811 North Fraser Way
Burnaby, BC V5J 5J2 Canada

 mail@keithpanel.com

 keithpanel.com

 604-987-4499

[Click here to learn more](#)